

LASER COMPATIBILITY CHART FOR OPTICAL INTEGRITY HOLMIUM LASER FIBERS

Laser Manufacturer	Laser Model Name	Fiber Size (micrometers)	Single-Use Fiber	Single-Use Fiber with Sheath	Reusable Fiber
Lumenis	Versa Pulse	200	P0012-0200SS	11141	-
		272	P0012-0272SS	11143	P0012-0272SSR
		300	P0012-0300SS	11145	P0012-0300SSR
		365	P0012-0365	-	P0012-0365R
		550	P0012-0550	-	P0012-0550R
		1000	P0012-1000	-	P0012-1000R
Dornier	H20	200	P0012-0200SS	11141	-
		272	P0012-0272SS	11143	P0012-0272SSR
		300	P0012-0300SS	11145	P0012-0300SSR
		365	P0012-0365	-	P0012-0365R
		550	P0012-0550	-	P0012-0550R
		1000	P0012-1000	-	P0012-1000R
AMS	Stonelight	200	11211*	11141	-
		272	10560	11143	10728
		300	10591	11145	11240*
		365	10548	-	10739
		550	10592	-	10741
		1000	11213*	-	11242*
Quanta	Litho	200	11211*	11141	-
		272	10560	11143	10728
		300	10591	11145	11240*
		365	10548	-	10739
		550	10592	-	10741
		1000	11213*	-	11242*
Convergent	Odyssey	200	10624*	11147*	-
		272	10625	11149*	10846*
		300	10626	11151*	10847*
		365	10627	-	10848*
		550	10628	-	10849*
		1000	11159*	-	10850*
KARL STORZ	Calculase I	200	11211	11141	-
		272	10560	11143	10728
		300	10591	11145	11240*
		365	10548	-	10739
		550	10592	-	10741
		1000	11213*	-	11242*

LASER COMPATIBILITY CHART FOR OPTICAL INTEGRITY HOLMIUM LASER FIBERS

Laser Manufacturer	Laser Name	Fiber Size (micrometers)	Single-use Fiber	Single-Use Fiber with Sheath	Reusable Fiber
Lisa Laser	Revolix/Sphinx	200	11211*	11141	-
		272	10560	11143	10728
		300	10591	11145	11240*
		365	10548	N/A	19739
		550	10592	N/A	10741
		1000	11213*	N/A	11242*
Trimedyne		200	10840*	11153*	-
		272	10841	11155*	10668*
		300	10842*	11157*	10669*
		365	10843*	N/A	10670*
		550	10844*	N/A	10671*
		1000	10845*	N/A	10672*

IMPORTANT NOTES:

Note 1: For availability and timeline of items denoted with an (*) asterisk please contact Optical Integrity directly.

Note 2: Customers currently purchasing Optical Integrity “P0012-XXXX” (Option A) laser fibers can substitute for these fibers for Option B fibers as follows:

Fiber Size (microns)	Single-Use Fiber Option A	Single-Use Fiber Option B	Reusable Fiber Option A	Reusable Fiber Option B
200	P0012-0200SS	11211	-	-
272	P0012-0272SS	10560	P0012-0272SSR	10728
300	P0012-0300SS	10591	P0012-0300SSR	11240*
365	P0012-0365	10548	P0012-0365R	10739
550	P0012-0550	10592	P0012-0550R	10741
1000	P0012-1000	11213	P0012-1000R	11242*

The Option B laser fibers listed above have a more slender sleeve/connector as shown below.

Option A Sleeve

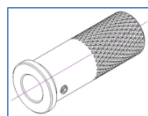

Option B Sleeve

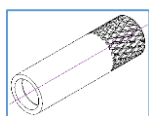

Note 3: This list is subject to change as new lasers and new fiber models are introduced. Also, not all fiber models are compatible with all lasers, so if a laser is not on this list, contact us and we will work with you to ensure that you receive a compatible fiber.

Note 4: Laser model names are trademarks of each respective laser manufacturer listed.